



# RED GRANITE FARM

ESTABLISHED 2007

## Native (-esque\*) Sun Garden

Bed size varies-plants can be added or deleted to fit your space.  
Each Square=1 sq ft

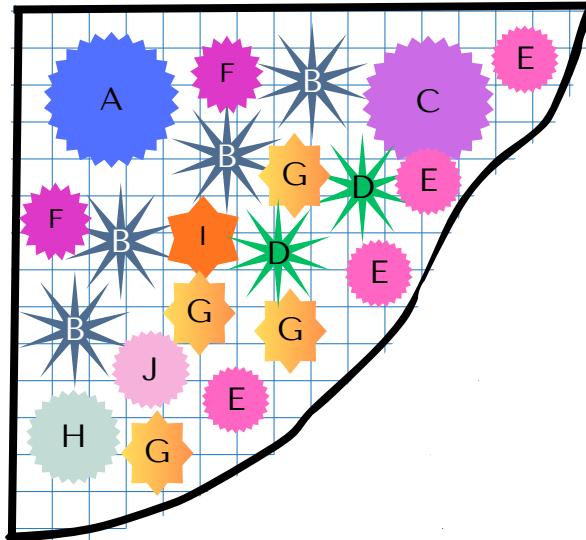
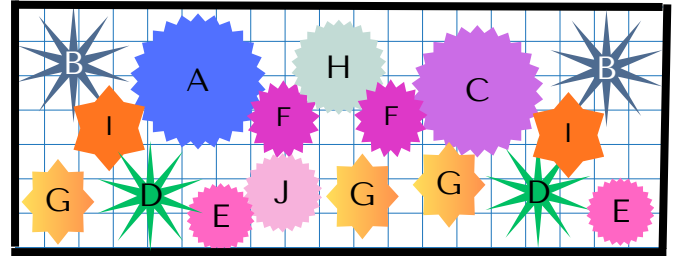

### Plant List

- A: Blue False Indigo (Baptisia)
- B: Little Bluestem
- C: Ironweed
- D: Prairie Dropseed
- E: Prairie Smoke
- F: Liatris
- G: Cheyenne Spirit Coneflower
- H: Rattlesnake Master
- I: Butterfly Milkweed
- J: Monarda bradburiana

Use the QR codes to find out more about each plant on our website



Full Sun



Ornamental Grasses

\*Not all plants are Native to Iowa, some are cultivars of Natives